



MIAMI-DADE
EXPRESSWAY
AUTHORITY

MDX Landscaping and Aesthetics Update

Juan C. Toledo, P.E.
Engineering Program Manager
&
Richard Johnson
Roadway Maintenance Engineer

July 23, 2007

MDX Aesthetics Enhancements Goals

- In July of 2003, the MDX Board adopted a policy that focused on developing roadway enhancements as an integral part of all roadway infrastructure and capacity improvements projects.
- Enhancements include:
 - Landscape Improvements
 - Noise Mitigation
 - Architectural Approaches
 - Greenways and Bike Paths

MDX System Wide Landscaping

Background History

- Conceptual designs began in Spring 2005 on SR 836, SR 112 and SR 874
- Landscape Design Criteria:
 - **Think Green**
 - **Provide native trees and plants using xeriscape principles**
 - **Removal existing invasive and exotic plant materials**
 - **Long range maintainability**
 - **Utilize landscaping to reduce the highway impacts on neighboring communities**
- Final designs complete in Summer 2006
- Implementation of landscaping began in Fall of 2006 and will continue through 2008

MDX System Wide Landscaping

SR 874

- As a result of the impacts incurred by Hurricanes Katrina and Wilma, priorities were shifted to the SR 874 corridor.
- Clearing of the hurricane damaged trees and debris resulted in expediting the design and installation of new plantings.
- This also provided the opportunity for using mixed planting schemes to benefit adjacent homeowners and MDX patrons.

MDX System Wide Landscaping

SR 874 after Hurricane Katrina and Wilma



MDX System Wide Landscaping

SR 874 Concept Design

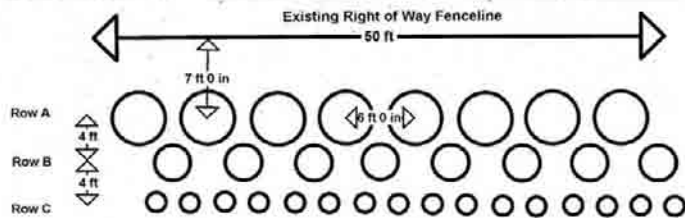

Row A. Green buttonwood single row planting of 10' - 12' height x 5' spread bush type trees planted on 6' center to center spacing.

Row B. Silver buttonwood single row planting of 4' - 5' height x 3' spread bush type trees planted on 6' center to center spacing.

Row C. Cocoplum single row planting of 2' - 3' height x 2' spread bush type shrubs planted on 3' center to center spacing.

NOTE: 4 ft. spacing between rows

Scale: 1" = 6'

SR 874 Landscape Restoration M.P. 5.7-6.3 Southbound

Tree Plan (section "A")

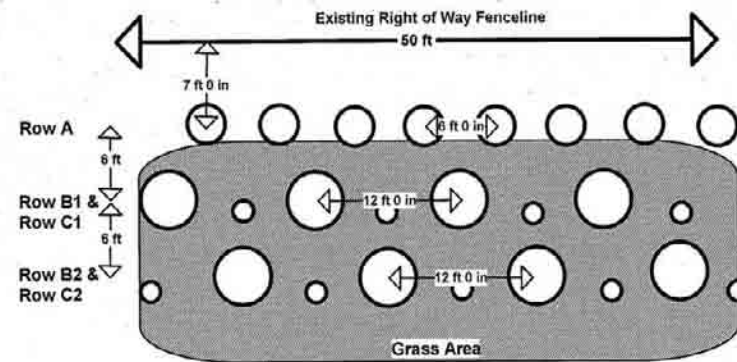

Row A. Areca Palm single row planting of 10' - 12' height x 5' spread planted on 6' center to center spacing.

Row B1. Sabal Palm staggered double row planting of 20' height back row and

Row B2. Sabal Palm 16' height front row planted on 12' center to center spacing. 6 ft. spacing between rows.

Row C1. Red Stopper staggered double row planting of 6' - 7' height x 2' spread alternating with Row B1 and

Row C2. Red Stopper alternating with Row B2 planted on 12' center to center spacing.

Grass Area. Fakahatchee grass infill planting of 1 gallon 18" height x 12" spread planted on 3' triangular spacing.

Scale: 1" = 6'

SR 874 Landscape Restoration M.P. 5.7-6.3 Southbound

Palm Plan (section "B")

MDX System Wide Landscaping

SR 874 after landscaping was completed



MDX System Wide Landscaping

SR 874 after landscaping was completed



MDX System Wide Landscaping

SR 874 after landscaping was completed



MDX System Wide Landscaping

SR 874 after landscaping was completed



MDX System Wide Landscaping

SR 878 Prior to New Plantings



MDX System Wide Landscaping

SR 878 Prior to New Plantings



MDX System Wide Landscaping

SR 878 Concept Design

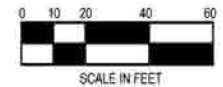

SR-878 PROPOSED LANDSCAPE IMPROVEMENTS



MDX System Wide Landscaping

SR 878 After New Plantings



MDX System Wide Landscaping

SR 878 After New Plantings



MDX System Wide Landscaping

SR 878 After New Plantings



MDX System Wide Landscaping

SR 878 after New Plantings



MDX System Wide Landscaping

SR 112 / N.W. 27th Avenue Pre-existing Condition

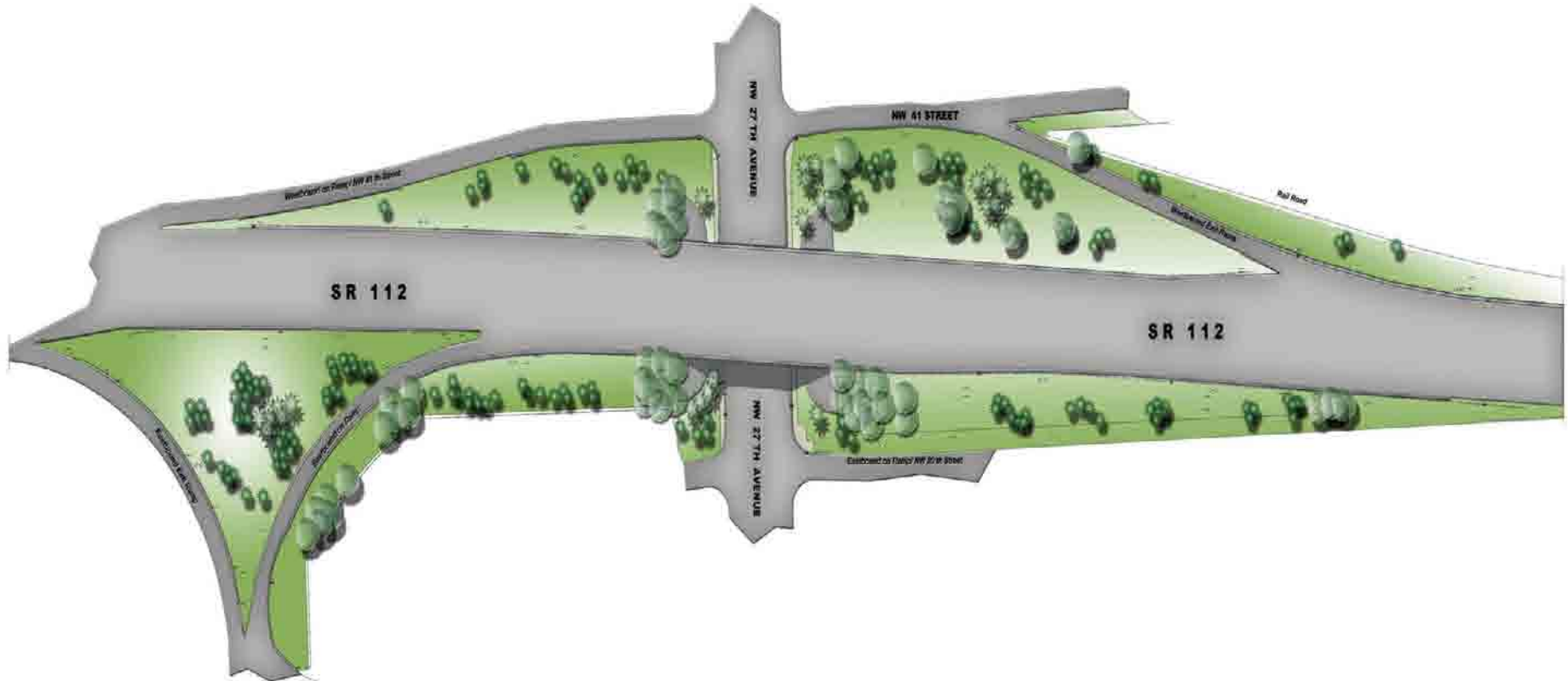

MDX INTERCHANGE - SR 112/27 AVE

EXISTING CONDITIONS

MDX System Wide Landscaping

SR 112 / N.W. 27th Avenue Concept Design

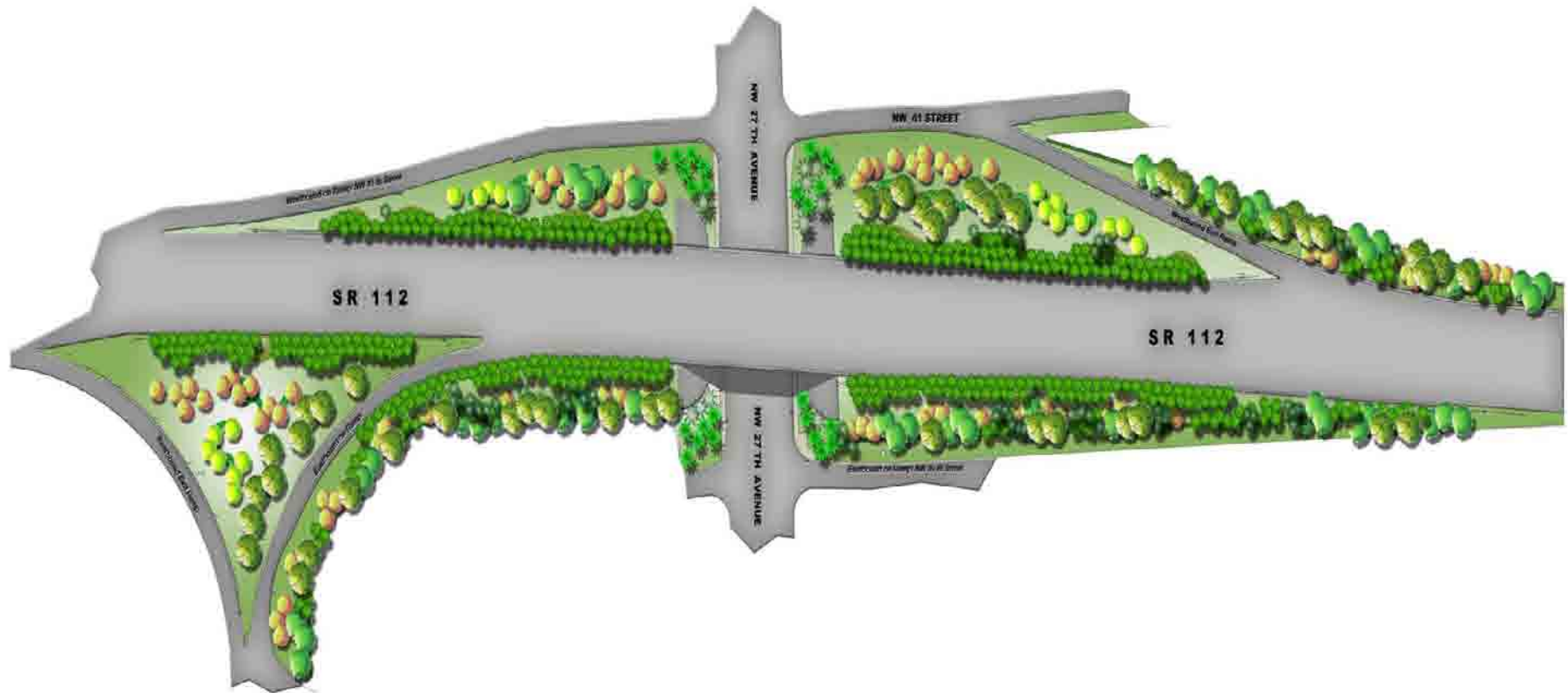

MDX INTERCHANGE - SR 112/27 AVE

CONCEPTUAL LANDSCAPE PLAN

MDX System Wide Landscaping

SR 112 / N.W. 27th Avenue After New Plantings



MDX System Wide Landscaping

SR 112 / N.W. 27th Avenue After New Plantings



MDX System Wide Landscaping

SR 112 Median After New Plantings



MDX System Wide Landscaping

SR 112 / N.W. 40th Street



MDX System Wide Landscaping

SR 112 / N.W. 39th Street



MDX System Wide Landscaping

SR 836 / N.W. 27th Avenue Pre-existing Condition

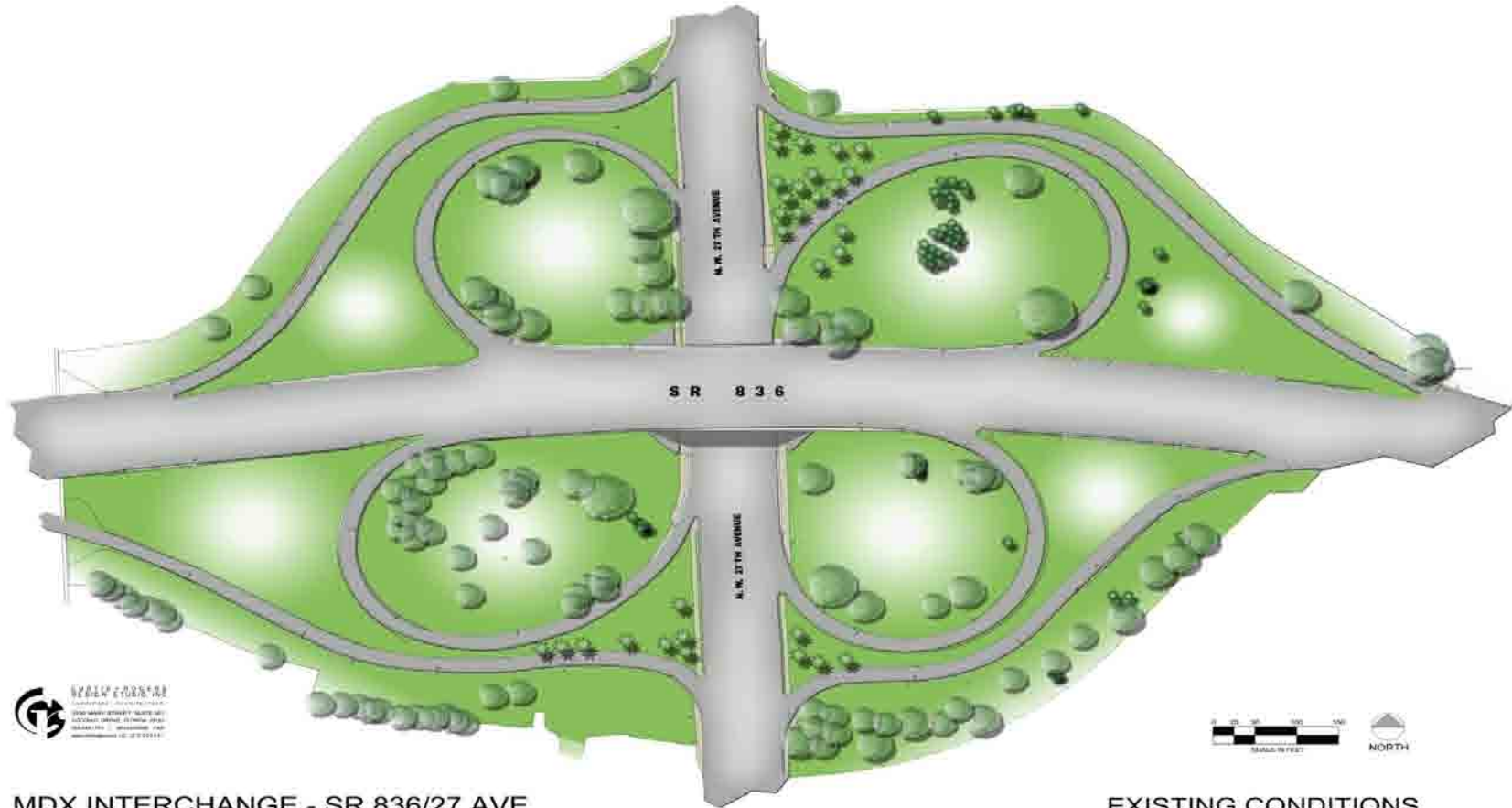

MDX INTERCHANGE - SR 836/27 AVE

EXISTING CONDITIONS

MDX System Wide Landscaping

SR 836 / N.W. 27th Avenue Pre-existing Condition



MDX System Wide Landscaping

SR 836 / N.W. 27th Avenue Pre-existing Condition



MDX System Wide Landscaping

SR 836 / N.W. 27th Avenue Pre-existing Condition



MDX System Wide Landscaping

SR 836 / N.W. 27th Avenue Pre-existing Condition



MDX System Wide Landscaping

SR 836 / N.W. 27th Avenue Concept Design



MDX INTERCHANGE - SR 836/27 AVE

CONCEPTUAL LANDSCAPE PLAN

MDX System Wide Landscaping

- SR 836 / N.W. 27th Avenue Concept Design



MDX INTERCHANGE - SR 836 / 27th AVENUE

TYPICAL SECTION



MDX System Wide Landscaping

SR 836 / N.W. 27th Avenue After Installation



MDX System Wide Landscaping

SR 836 / N.W. 27th Avenue After Installation



MDX System Wide Landscaping

SR 836 / N.W. 27th Avenue After Installation



MDX System Wide Landscaping

SR 836 / N.W. 27th Avenue After Installation



MDX System Wide Landscaping

SR 836 / N.W. 27th Avenue After Installation



MDX System Wide Landscaping

SR 836 / N.W. 37th Avenue after installation



MDX System Wide Landscaping

Future Landscape Project MDX 83617

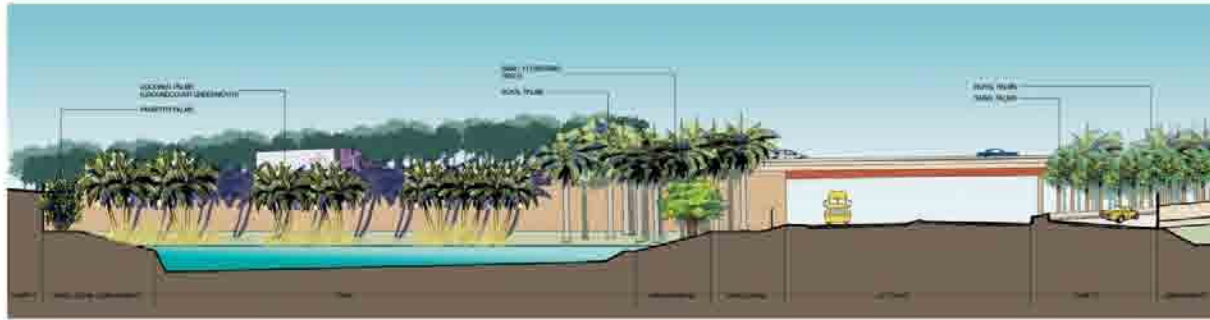

137 TH AVE. INTERCHANGE - NORTH ELEVATION



137 TH AVE. INTERCHANGE - WEST ELEVATION



SR-83617 PROPOSED LANDSCAPE IMPROVEMENTS



MDX System Wide Landscaping

Future Landscape Project MDX 83617

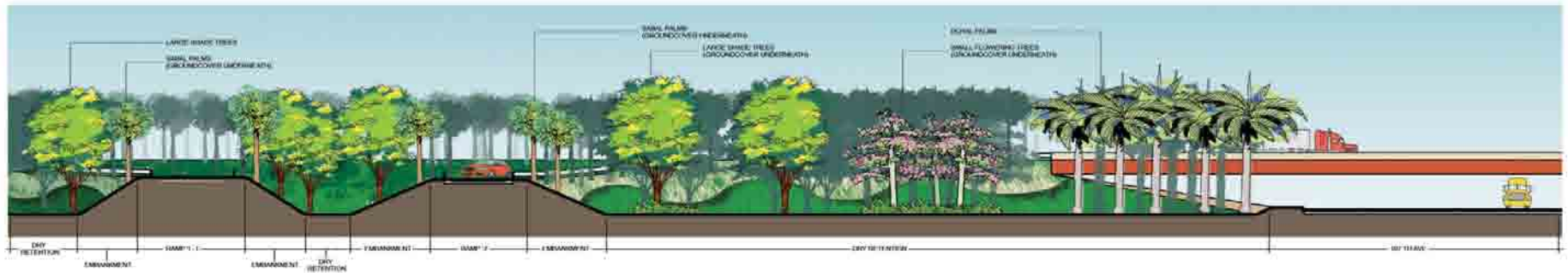

107 TH AVENUE - ELEVATION

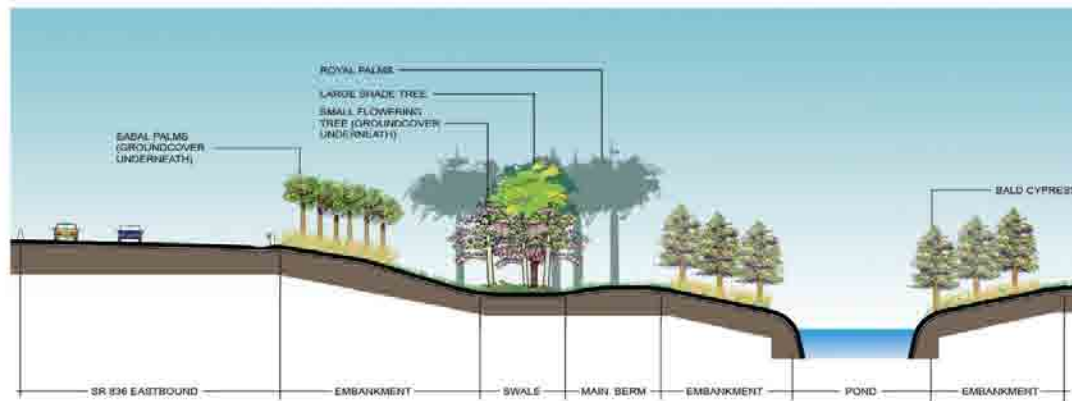

STATION 573 + 00 - SECTION

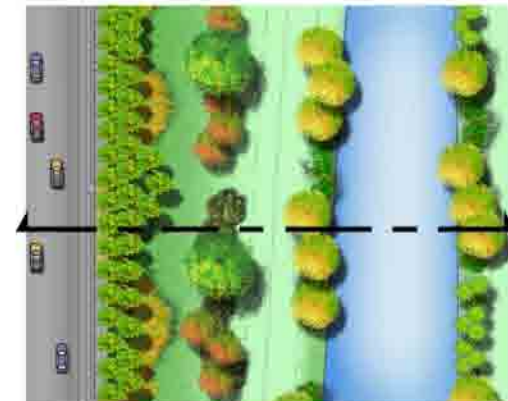

STATION 573 + 00 - PLAN VIEW



SR-83617 PROPOSED LANDSCAPE IMPROVEMENTS



MDX System Wide Landscaping

Future Landscape Project MDX 83617

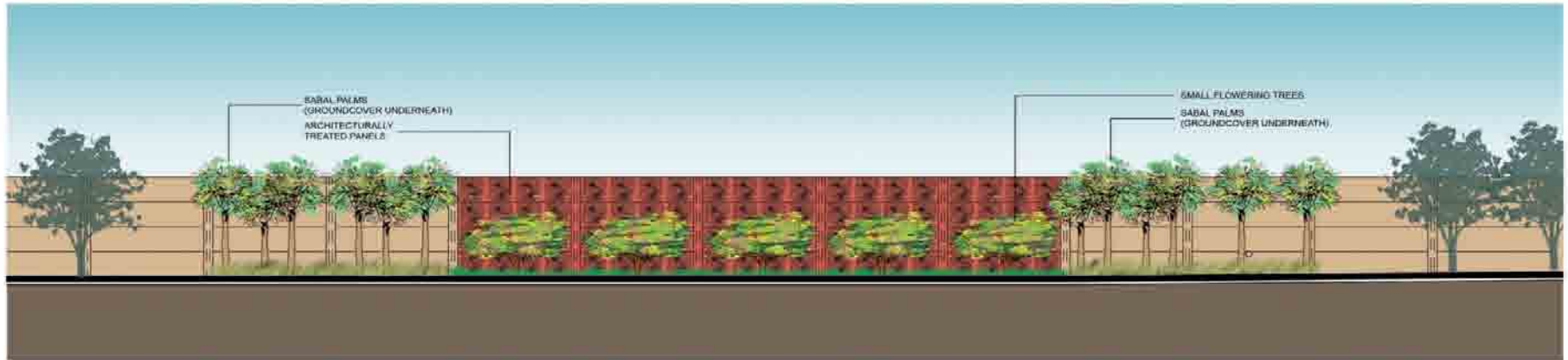

ACCENT PANEL - ELEVATION



12 TH ST. BRIDGE - VIEW 1



12 TH ST. BRIDGE - VIEW 2



SR-83617 PROPOSED LANDSCAPE IMPROVEMENTS



MDX System Wide Landscaping

MDX Projects 87404 / 87407 – Landscaping & Aesthetics

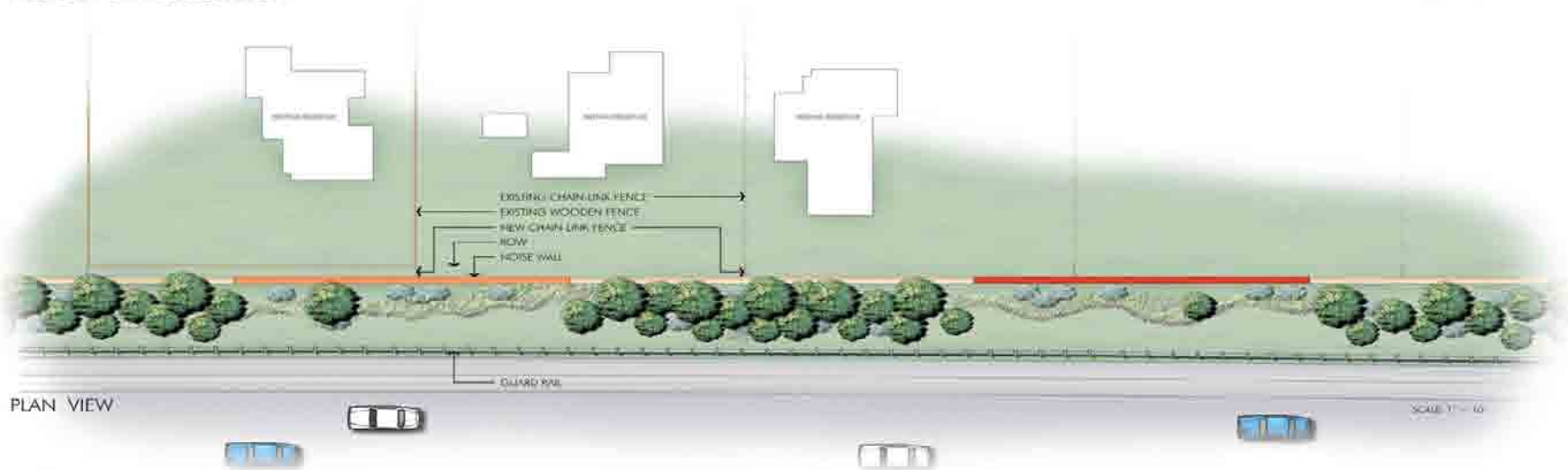
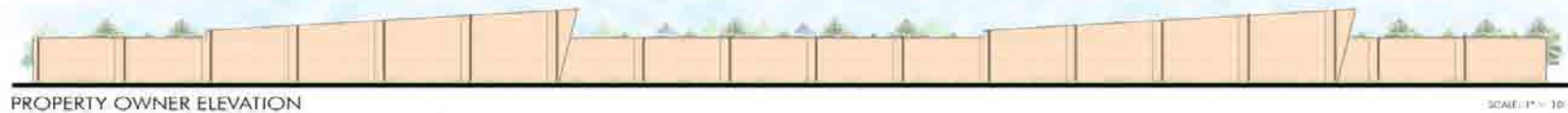

SR-874 PROPOSED LANDSCAPE IMPROVEMENTS



MDX System Wide Aesthetics

SR 836 Corridor Aesthetic Color Scheme

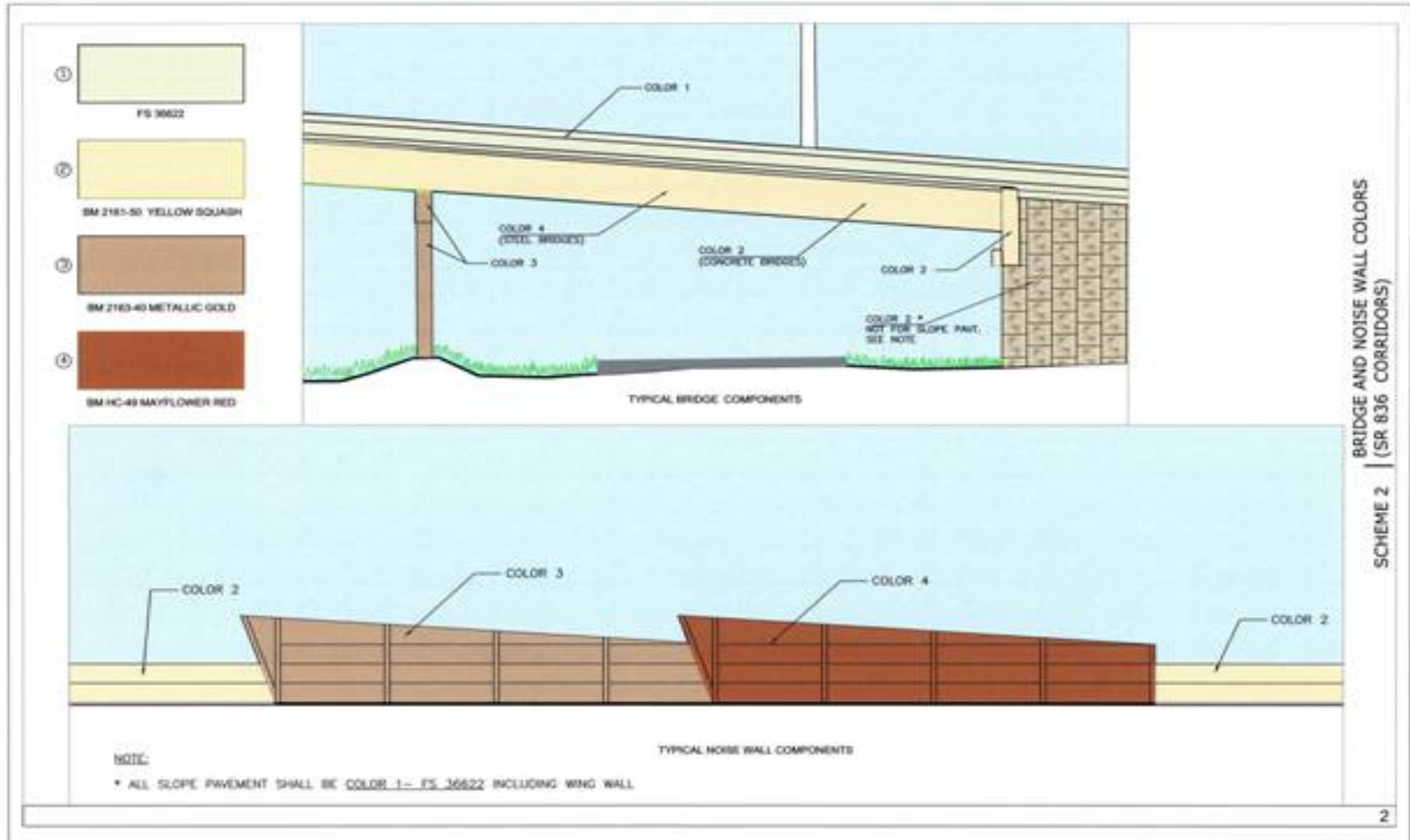

MDX System Wide Aesthetics

SR 112 & SR 924 Corridors Aesthetic Color Scheme

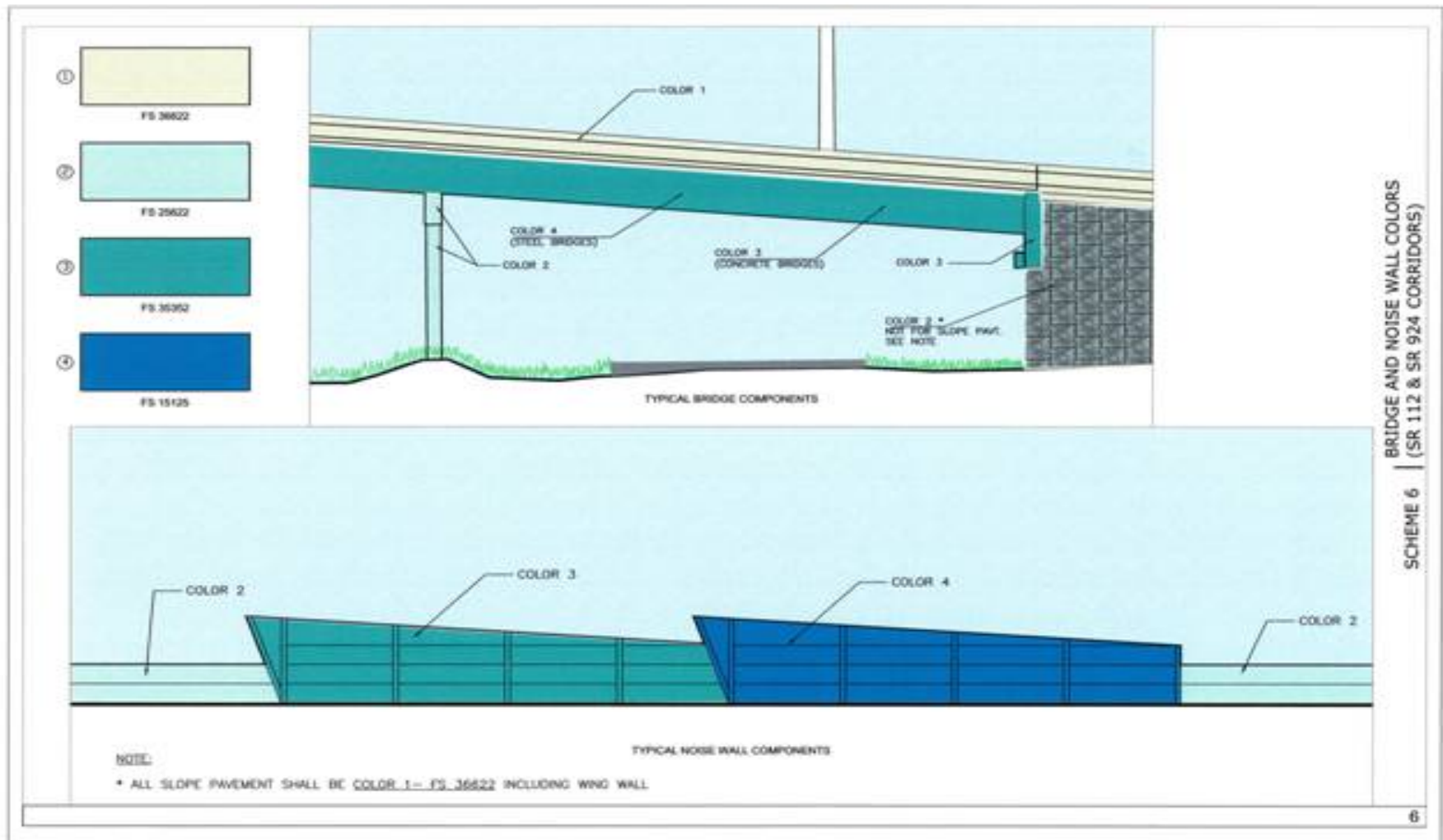

MDX System Wide Aesthetics

SR 874 & SR 878 Corridors Aesthetic Color Scheme

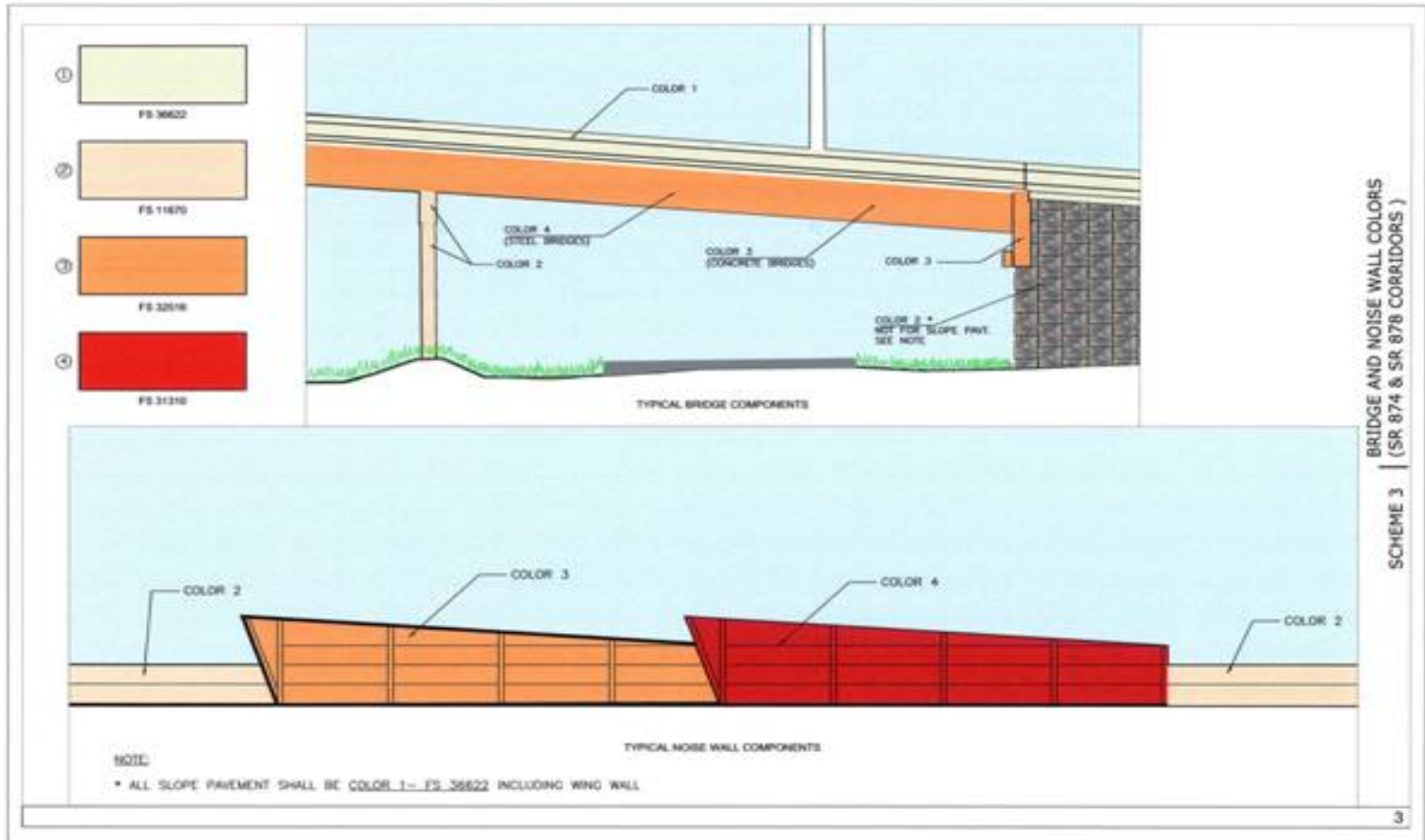

MDX System Wide Aesthetics

SR 836 Extension at N.W. 137th Avenue



MDX System Wide Aesthetics

SR 836 Extension at N.W. 137th Avenue



MDX System Wide Aesthetics

SR 836 Extension – Toll Plaza



MDX System Wide Aesthetics

SR 112 at Le Jeune Road – Bridge Painting Project



MDX System Wide Aesthetics

MDX Sign Structures

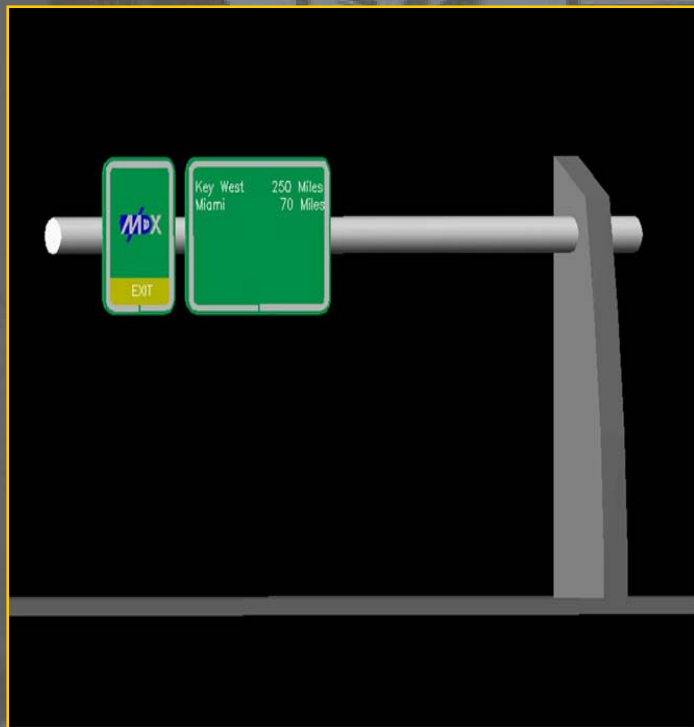

MDX System Wide Aesthetics

SR 836 Extension Overhead and Cantilever Signs



MDX System Wide Aesthetics

SR 836 Overhead ORT Gantry and Sign Structure



MDX System Wide Aesthetics

SR 836 Extension - Bike Path between N.W. 107th Avenue and N.W. 87th Avenue





MIAMI-DADE
EXPRESSWAY
AUTHORITY

MDX Landscaping and Aesthetics Update