



DEPARTMENT OF REGULATORY AND ECONOMIC RESOURCES (RER)
BOARD AND CODE ADMINISTRATION DIVISION

MIAMI-DADE COUNTY
PRODUCT CONTROL SECTION
11805 SW 26 Street, Room 208
Miami, Florida 33175-2474
T (786) 315-2590 F (786) 315-2599

www.miamidade.gov/economy

NOTICE OF ACCEPTANCE (NOA)

Aluwind S.A.
1446 Garden Road
Weston, FL 33326

SCOPE:

This NOA is being issued under the applicable rules and regulations governing the use of construction materials. The documentation submitted has been reviewed and accepted by Miami-Dade County RER- Product Control Section to be used in Miami Dade County and other areas where allowed by the Authority Having Jurisdiction (AHJ).

This NOA shall not be valid after the expiration date stated below. The Miami-Dade County Product Control Section (In Miami Dade County) and/or the AHJ (in areas other than Miami Dade County) reserve the right to have this product or material tested for quality assurance purposes. If this product or material fails to perform in the accepted manner, the manufacturer will incur the expense of such testing and the AHJ may immediately revoke, modify, or suspend the use of such product or material within their jurisdiction. RER reserves the right to revoke this acceptance if it is determined by Miami-Dade County Product Control Section that this product or material fails to meet the requirements of the applicable building code.

This product is approved as described herein and has been designed to comply with the High Velocity Hurricane Zone of the Florida Building Code.

DESCRIPTION: Imperia Postless Glass Railing System - LMI

APPROVAL DOCUMENT: Drawing No. ALW002, titled "Imperia Glass Railing", sheets 1 through 3 of 3, prepared by Building Drops, Inc., signed and sealed by Hermes F. Norero, P.E., on March, 14, 2024, bearing Miami-Dade County Product Control Revision stamp with the Notice of Acceptance number and the expiration date by the Miami-Dade County Product Control Section.

MISSILE IMPACT RATING: Large and Small Missile Impact Resistant

LABELING: Each unit shall bear a permanent label with the manufacturer's name or logo, city, state and the following statement: "Miami-Dade County Product Control Approved", unless otherwise noted herein.

RENEWAL of this NOA shall be considered after a renewal application has been filed and there has been no change in the applicable building code negatively affecting the performance of this product.

TERMINATION of this NOA will occur after the expiration date or if there has been a revision or change in the materials, use, and/or manufacture of the product or process. Misuse of this NOA as an endorsement of any product, for sales, advertising or any other purposes shall automatically terminate this NOA. Failure to comply with any section of this NOA shall be cause for termination and removal of NOA.

ADVERTISEMENT: The NOA number preceded by the words Miami-Dade County, Florida, and followed by the expiration date may be displayed in advertising literature. If any portion of the NOA is displayed, then it shall be done in its entirety.

INSPECTION: A copy of this entire NOA shall be provided to the user by the manufacturer or its distributors and shall be available for inspection at the job site at the request of the Building Official. The structural adequacy of the supporting structures is not part of this approval & shall be reviewed by the corresponding Building Dept.

This NOA revises NOA #20-1021.03 and consists of this page 1, evidence submitted page E-1 as well as approval document mentioned above.

The submitted documentation was reviewed by **Helmy A. Makar, P.E., M.S.**



Helmy A. Makar
06/20/24

NOA No. 24-0410.03
Expiration Date: 12/17/2025
Approval Date: 06/20/2024

NOTICE OF ACCEPTANCE: EVIDENCE SUBMITTED

A. DRAWINGS

1. *Drawing No. ALW002, titled Imperia Glass Railing, sheets 1 through 3 of 3, issued by Building Drops, Inc., signed and sealed by Hermes F. Norero, P.E., on 10/08/20.*

B. TESTS

1. *Test Report No. BT-AWD-19-001, by Blackwater Testing, Inc., dated 06/04/2020, per TAS 202-94, TAS 201-94, Distributed Loads @ 50 lb/ft, Concentrated Loads @ 200 lb, and ANSI Z97.1, report signed and sealed by Constantin Bortes, P.E.*

C. CALCULATIONS

1. *Calculation titled "Imperia Glass Railing", 27 sheets, dated 06/17/2020, prepared by Building Drops, Inc., signed and sealed by Hermes F. Norero, P.E., on 06/17/20.*

D. QUALITY ASSURANCE

1. *By Miami-Dade County Department of Regulatory and Economic Resources.*

E. MATERIAL CERTIFICATIONS

1. *None.*

F. OTHERS

1. *FBC, 2020 Edition, compliance letter, dated June 17, 2020, prepared by Building Drops, Inc., signed and sealed by Hermes F. Norero, P.E., on June 17, 2020.*
2. *Distributor Agreement, signed by Paula Romero (Distributor).*

NEW EVIDENCE SUBMITTED

A. DRAWINGS

1. *Drawing No. ALW002, titled "Imperia Glass Railing", sheets 1 through 3 of 3, prepared by Building Drops, Inc., signed and sealed by Hermes F. Norero, P.E., on March, 14, 2024.*

B. TESTS

1. *None.*

C. CALCULATIONS

1. *None.*

D. QUALITY ASSURANCE

1. *By Miami-Dade County Department of Regulatory and Economic Resources.*

E. MATERIAL CERTIFICATIONS

1. *None.*

F. OTHERS

1. *Florida Building Code, 2023 Edition, compliance letter, dated 03/19/2024, prepared by Building Drops, Inc., signed and sealed by Hermes F. Norero, P.E.*
2. *Distributor Agreement, signed by Paula Romero (Distributor).*

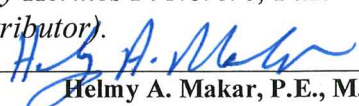
Helmy A. Makar, P.E., M.S.
Product Control Section Supervisor
NOA No. 24-0410.03
Expiration Date: 12/17/2025
Approval Date: 06/20/2024

ALUWIND, S.A.

IMPERIA GLASS RAILING



ALUWIND, S.A.
1446 GARDEN RD.
WESTON, FL 33326
PH: (786) 498-2931

GENERAL NOTES:

1. THE PRODUCT SHOWN HEREIN IS DESIGNED AND MANUFACTURED TO COMPLY WITH THE 8TH EDITION OF THE FLORIDA BUILDING CODE (FBC), **INCLUDING** HVHZ AND HAS BEEN EVALUATED ACCORDING TO THE FOLLOWING:
 - ANSI Z97.1
 - TAS 201-94
 - TAS 202-94
2. ADEQUACY OF THE EXISTING STRUCTURAL CONCRETE/MASONRY, 2X AND METAL STUD FRAMING AS A MAIN WIND FORCE RESISTING SYSTEM CAPABLE OF WITHSTANDING AND TRANSFERRING APPLIED PRODUCT LOADS TO THE FOUNDATION IS THE RESPONSIBILITY OF THE ENGINEER OR ARCHITECT OF RECORD FOR THE PROJECT OF INSTALLATION.
3. 1X AND 2X BUCKS (WHEN USED) SHALL BE DESIGNED AND ANCHORED TO PROPERLY TRANSFER ALL LOADS TO THE STRUCTURE. BUCK DESIGN AND INSTALLATION IS THE RESPONSIBILITY OF THE ENGINEER OR ARCHITECT OF RECORD FOR THE PROJECT OF INSTALLATION.
4. THE INSTALLATION DETAILS DESCRIBED HEREIN ARE GENERIC AND MAY NOT REFLECT ACTUAL CONDITIONS FOR A SPECIFIC SITE. IF SITE CONDITIONS CAUSE INSTALLATION TO DEVIATE FROM THE REQUIREMENTS DETAILED HEREIN, A LICENSED ENGINEER OR ARCHITECT SHALL PREPARE SITE SPECIFIC DOCUMENTS FOR USE WITH THIS DOCUMENT.
5. APPROVED IMPACT PROTECTIVE SYSTEM **IS NOT REQUIRED** TO PROTECT THIS PRODUCT IN AREAS REQUIRING IMPACT RESISTANCE.
6. RAILING MATERIAL: ALUMINUM 6063-T6.
7. GLASS MEETS THE REQUIREMENTS OF ASTM E1300. SEE GLAZING DETAIL ON SHEET 1.

INSTALLATION NOTES:

1. ONE (1) INSTALLATION ANCHOR IS REQUIRED AT EACH ANCHOR LOCATION SHOWN.
2. THE NUMBER OF INSTALLATION ANCHORS DEPICTED IS THE MINIMUM NUMBER OF ANCHORS TO BE USED FOR PRODUCT INSTALLATION OF THE MAXIMUM SIZE LISTED.
3. INSTALL INDIVIDUAL INSTALLATION ANCHORS WITHIN A TOLERANCE OF ±1/2 INCH THE DEPICTED LOCATION & SPACING IN THE ANCHOR LAYOUT DETAILS (I.E., WITHOUT CONSIDERATION OF TOLERANCES). TOLERANCES ARE NOT CUMULATIVE FROM ONE INSTALLATION ANCHOR TO THE NEXT.
4. MINIMUM EMBEDMENT AND EDGE DISTANCE EXCLUDE WALL FINISHES, INCLUDING BUT NOT LIMITED TO STUCCO, FOAM, BRICK VENEER, AND SIDING.
5. INSTALLATION ANCHORS AND ASSOCIATED HARDWARE MUST BE MADE OF CORROSION RESISTANT MATERIAL OR HAVE A CORROSION RESISTANT COATING.
6. FOR HOLLOW BLOCK AND GROUT FILLED BLOCK, DO NOT INSTALL INSTALLATION ANCHORS INTO MORTAR JOINTS. EDGE DISTANCE IS MEASURED FROM FREE EDGE OF BLOCK OR EDGE OF MORTAR JOINT INTO FACE SHELL OF BLOCK.
7. INSTALLATION ANCHORS SHALL BE INSTALLED IN ACCORDANCE WITH ANCHOR MANUFACTURER'S INSTALLATION INSTRUCTIONS, AND ANCHORS SHALL NOT BE USED IN SUBSTRATES WITH STRENGTHS LESS THAN THE MINIMUM STRENGTH SPECIFIED BY THE ANCHOR MANUFACTURER.

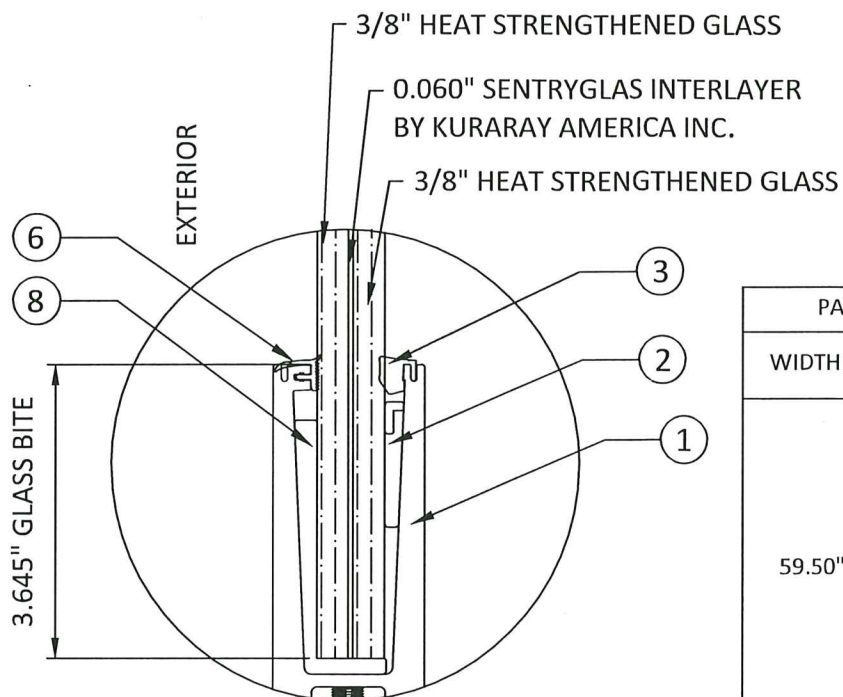

GLAZING DETAIL

TABLE OF CONTENTS	
SHEET	SHEET DESCRIPTION
1	GENERAL NOTES, ELEVATION, AND GLAZING DETAIL
2	ANCHOR DETAILS
3	BILL OF MATERIALS AND COMPONENTS

PANEL SIZE		ANCHOR TYPE	DESIGN PRESSURE	O.C. SPACING	MISSILE IMPACT RATING
WIDTH	HEIGHT				
59.50"	44"	HILTI HY-200 @5500 PSI CONCRETE	+65/-65 PSF	9.840"	SMALL & LARGE MISSILE IMPACT
		DEWALT TITEN HD @8000 PSI CONCRETE	+55/-55 PSF		
		DEWALT TITEN HD @5500 PSI CONCRETE	+45/-45 PSF	4.920"	
			+65/-65 PSF		

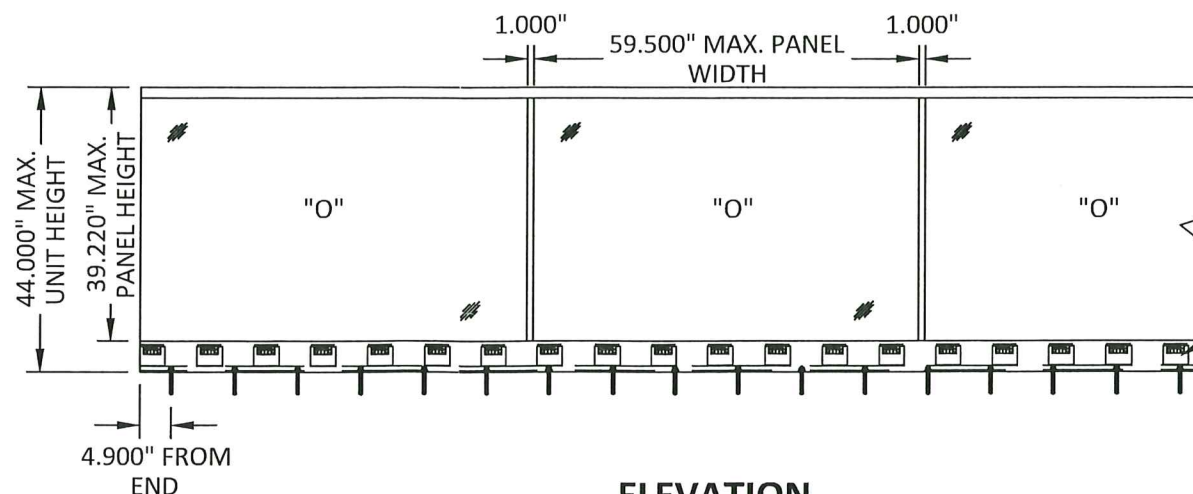

ELEVATION

13/16" LAMINATED GLASS

PRODUCT REVISED
as complying with the Florida
Building Code
Acceptance No. 24-0410-03
Expiration Date 12/17/2025
By *Hermes F. Norero*
Miami Local Product Control

IMPERIA GLASS RAILING
GENERAL NOTES, ELEVATION, AND GLAZING DETAIL

PREPARED BY: **BUILDING DROPS, INC.**
1900 NE MIAMI COURT, STE. 2-15
MIAMI, FL 33132
PH: (954) 999-8478
FAX: (954) 744-4738
WEB: www.buildingdrops.com

BD
BUILDING DROPS

REMARKS	BY	DATE
2023 CODE CHANGE	SH	03.14.24

THE INSTALLATION DETAILS DESCRIBED HEREIN ARE GENERIC AND MAY NOT REFLECT ACTUAL CONDITIONS FOR A SPECIFIC SITE. IF SITE CONDITIONS CAUSE INSTALLATION TO DEVIATE FROM THE REQUIREMENTS DETAILED HEREIN, A LICENSED ENGINEER OR ARCHITECT SHALL PREPARE SITE SPECIFIC DOCUMENTS FOR USE WITH THIS DOCUMENT.

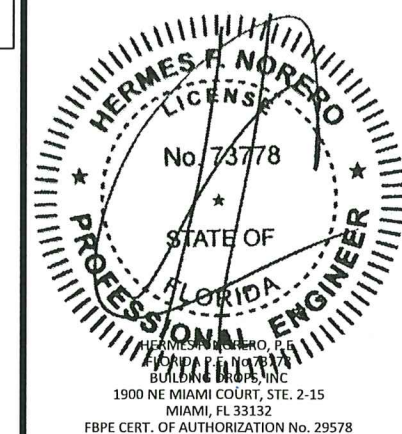

Digitally signed by Hermes F. Norero, P.E.
Reason: I am approving this document
Date: 2024.04.08 15:51:14 -04'00'

DATE:	06.17.20
DWG. BY:	LL
CHK. BY:	HFN
SCALE:	NTS
DWG. #:	ALW002

SHEET
1

IMPERIA GLASS RAILING, TOP OF SLAB - LARGE MISSILE IMPACT GLASS - 13/16" HEAT STRENGTHENED LAMINATED WITH 0.060" SENTRYGLAS

ANCHOR OPTION #1:

- \varnothing 3/8" THREADED ROD PLACED IN CONCRETE WITH HILTI HY200 CHEMICAL ANCHORING SYSTEM

ANCHOR OPTION #2:

- \varnothing 3/8" STAINLESS STEEL TITEN HD MECHANICAL ANCHORING SYSTEM

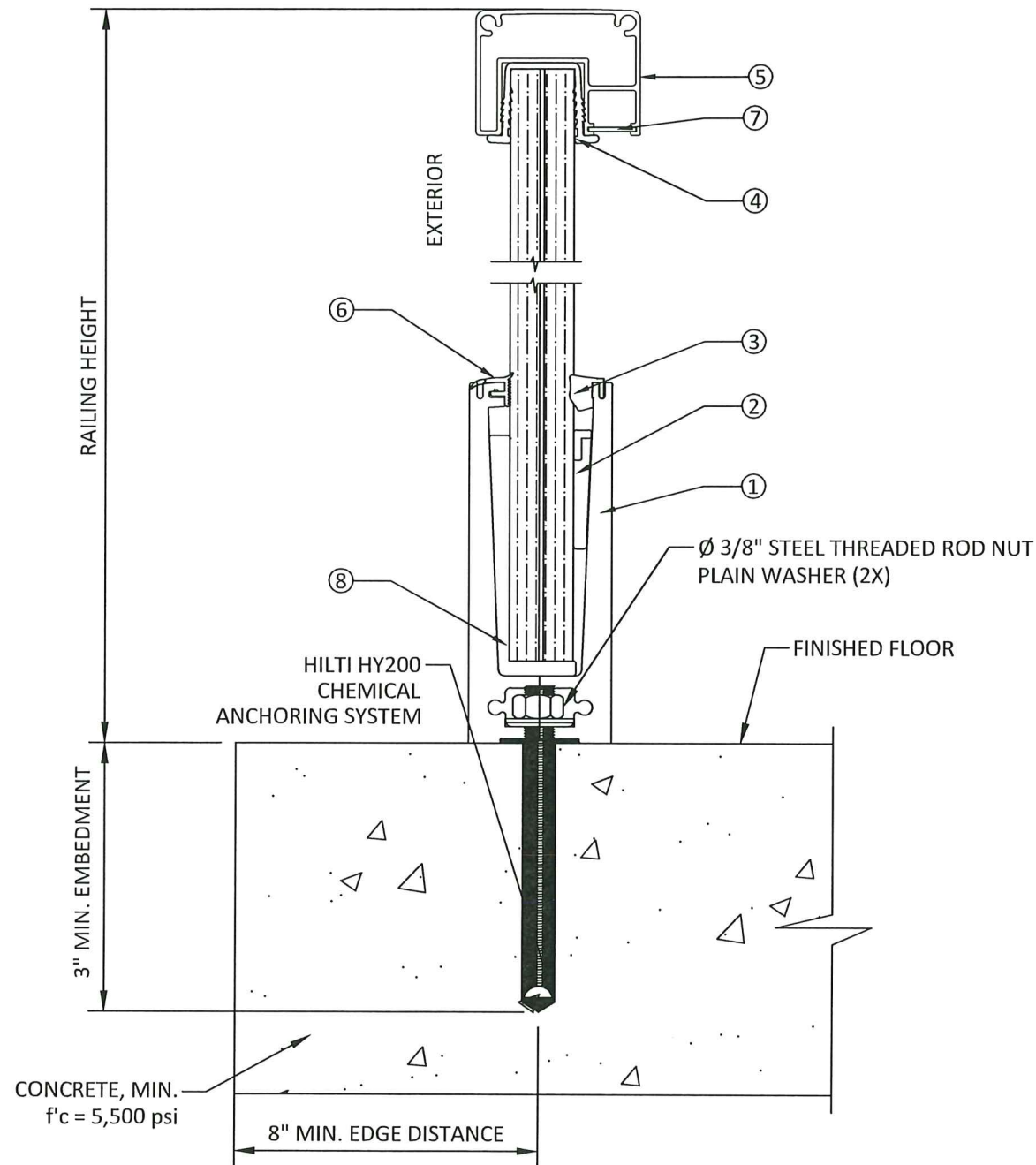

ANCHOR OPTION #1

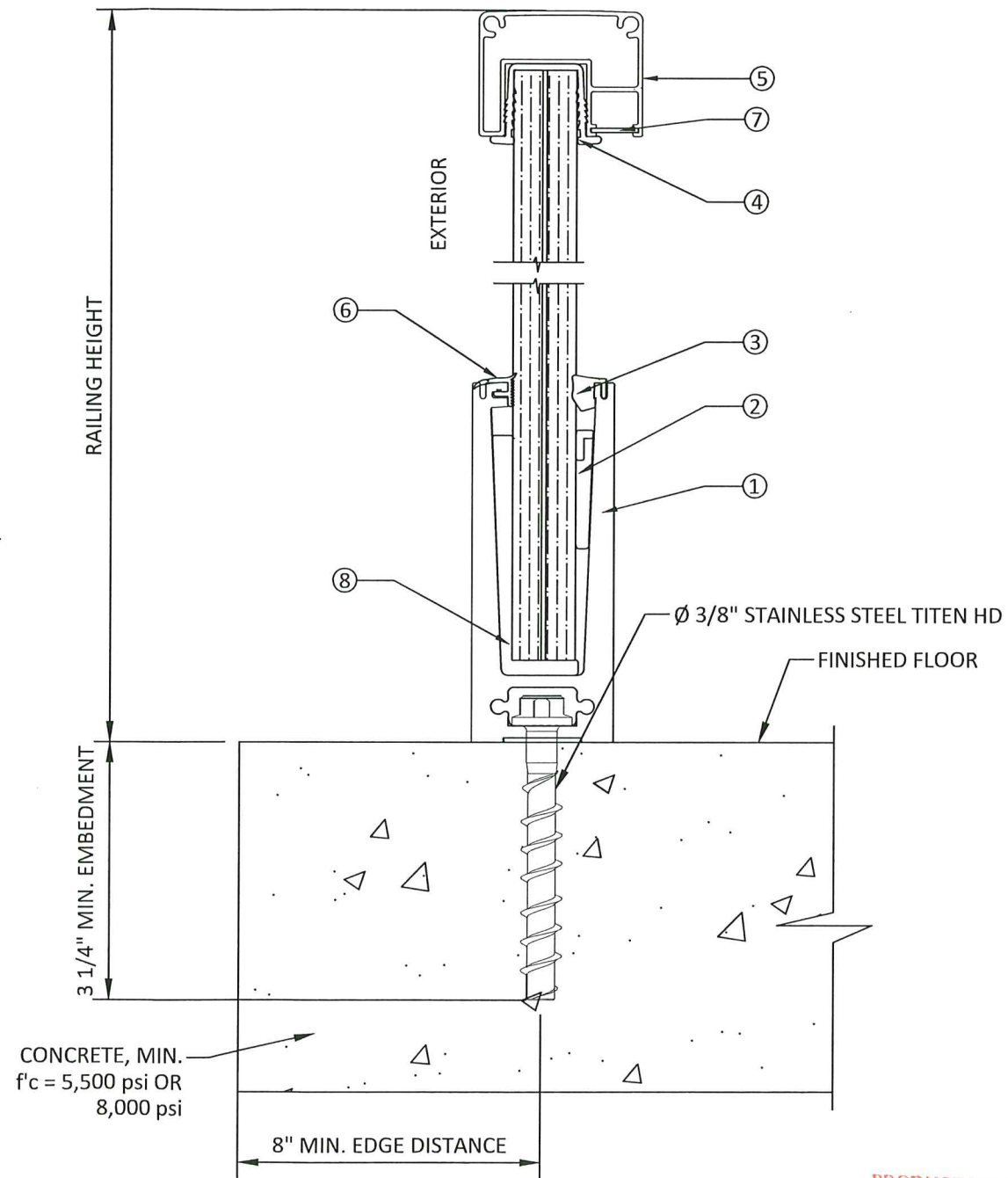

ANCHOR OPTION #2

PRODUCT REVISED
as complying with the Florida
Building Code
Acceptance No. 24-0410.03
Expiration Date 12/17/2025
By *Hely A. Miller*
Miami Data Product Control



ALUWIND, S.A.
1446 GARDEN RD.
WESTON, FL 33326
PH: (786) 498-2931

TITLE:
IMPERIA GLASS RAILING
ANCHOR DETAILS

PREPARED BY:
BUILDING DROPS, INC.
1900 NE MIAMI COURT, STE. 2-15
MIAMI, FL 33132
PH: (954) 399-8478
FAX: (954) 744-4738
WEB: www.buildingdrops.com

REMARKS	BY	DATE
2023 CODE CHANGE	SH	03.14.24

THE INSTALLATION DETAILS DESCRIBED HEREIN ARE GENERIC AND MAY NOT REFLECT ACTUAL CONDITIONS FOR A SPECIFIC SITE. IF SITE CONDITIONS CAUSE INSTALLATION TO DEVIATE FROM THE REQUIREMENTS DETAILED HEREIN, A LICENSED ENGINEER OR ARCHITECT SHALL PREPARE SITE SPECIFIC DOCUMENTS FOR USE WITH THIS DOCUMENT.

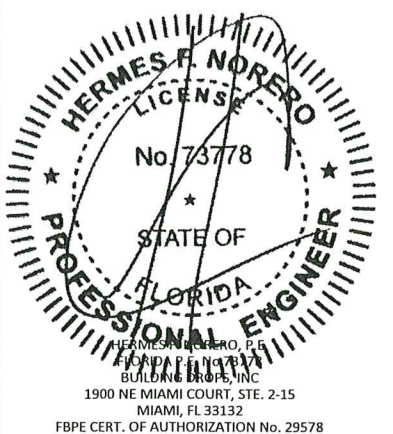

DATE:	06.17.20
DWG. BY:	LL
CHK. BY:	HFN
SCALE:	NTS
DWG. #:	ALW002

SHEET
2
OF 3

BILL OF MATERIALS

ITEM #	PROFILE	DESCRIPTION	MATERIAL	MANUFACTURER/REMARKS
1	AW-9100	BASE SHOE	ALUM. 6063-T6	ALUWIND, S.A.
2	-	PLASTIC CHOCK (3.5" LENGTH)	ABS	XIAMEN YIZHOU IMP. & EXP. CO.
3	2637	INTERIOR GLAZING GASKET	RUBBER (EPDM)	RUBBER S.R.L.
4	2623	HAND RAIL RUBBER GASKET	RUBBER (EPDM)	RUBBER S.R.L.
5	AW-1001	HAND RAIL	ALUM. 6063-T6	ALUWIND, S.A.
6	2775	EXTERIOR GASKET	RUBBER (EPDM)	RUBBER S.R.L.
7	-	DIFFUSER	HIGH IMPACT POLYSTYRENE (HIPS)	-
8	2777	L SETTING BLOCK (4" LENGTH)	RUBBER (EPDM)	RUBBER S.R.L.



ALUWIND, S.A.
1446 GARDEN RD.
WESTON, FL 33326
PH: (786) 498-2931

TITLE: IMPERIA GLASS RAILING
BILL OF MATERIAL AND COMPONENTS

PREPARED BY: BUILDING DROPS, INC.
1900 NE MIAMI COURT, STE. 2-15
MIAMI, FL 33132
PH: (954) 959-8478
FAX: (954) 744-4738
WEB: www.buildingdrops.com



REMARKS	BY	DATE
2023 CODE CHANGE	SH	03.14.24

THE INSTALLATION DETAILS DESCRIBED HEREIN ARE GENERIC AND MAY NOT REFLECT ACTUAL CONDITIONS FOR A SPECIFIC SITE. IF SITE CONDITIONS CAUSE INSTALLATION TO DEVIATE FROM THE REQUIREMENTS DETAILED HEREIN, A LICENSED ENGINEER OR ARCHITECT SHALL PREPARE SITE SPECIFIC DOCUMENTS FOR USE WITH THIS DOCUMENT.

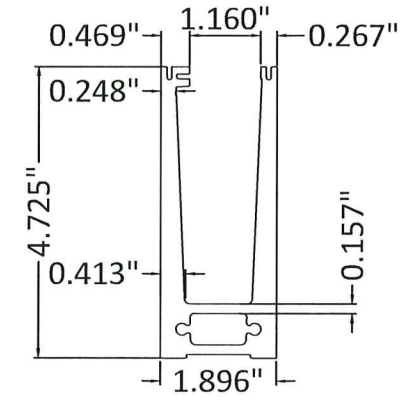
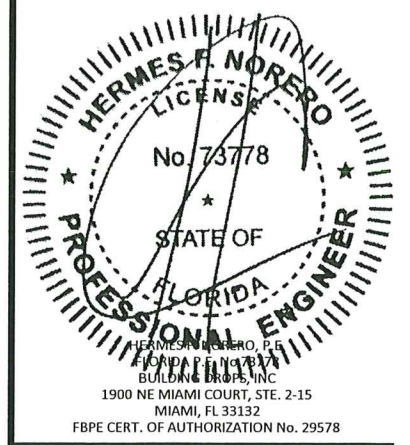

① BASE SHOE
AW 9001 6063-T6

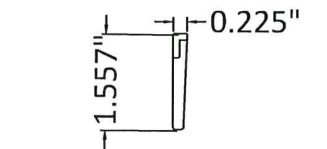

② PLASTIC CHOCK
ABS

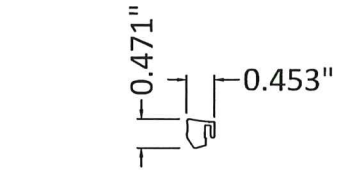

③ INTERIOR GLAZING GASKET
2637 EPDM

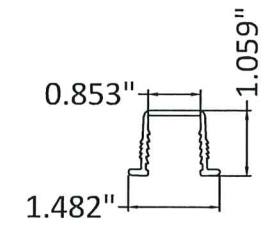

④ HAND RAIL GASKET
2623 EPDM

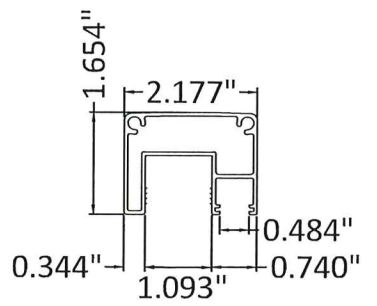

⑤ HAND RAIL
AW 1001 6063-T6

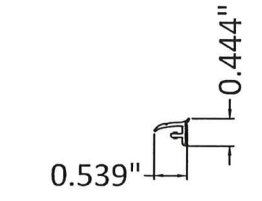

⑥ EXTERIOR GASKET
2775 EPDM

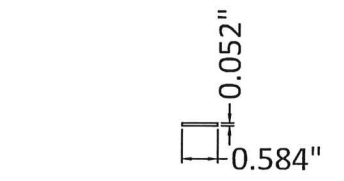

⑦ DIFFUSER
HIPS

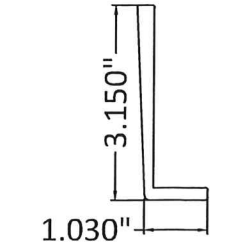

⑧ L SETTING BLOCK
2777 EPDM

PLASTIC CHOCK PROPERTIES

COMPOSITION: ETHYLENE COPOLYMER (>99%)
VINYL ACETATE (<0.3%)
FLASH POINT: 260 °C (500 °F)

EPDM PROPERTIES

TENSILE STRENGTH: 7 MPa (1.015 ksi)
TEAR RESISTANCE: 18 N/mm (102.782 lb/in)
AVG. HARDNESS: 70 +/- 5 (SHORE A)
PERCENT ELONGATION: 270 %
MIN. SVC. TEMPERATURE: -30 °C (-22 °F)
MAX. SVC. TEMPERATURE: 120 °C (248 °F)

NOTE: OPTIONAL L.E.D LIGHTS AND CORRESPONDING ELECTRICAL WORK IS OUTSIDE THE SCOPE OF THIS APPROVAL AND SHALL BE REVIEWED BY AHJ.

PRODUCT REVISED
as complying with the Florida
Building Code
Acceptance No. 24-0910-03
Expiration Date 12/17/2025
By: *[Signature]*
Miami Dept. Product Control

DATE: 06.17.20

DWG. BY: LL	CHK. BY: HFN
SCALE: NTS	
DWG. #: ALW002	